



FREEDOM WM MOTOR UPGRADE

Kit No:SR0097

Kits

PACKAGE CONTENTS:

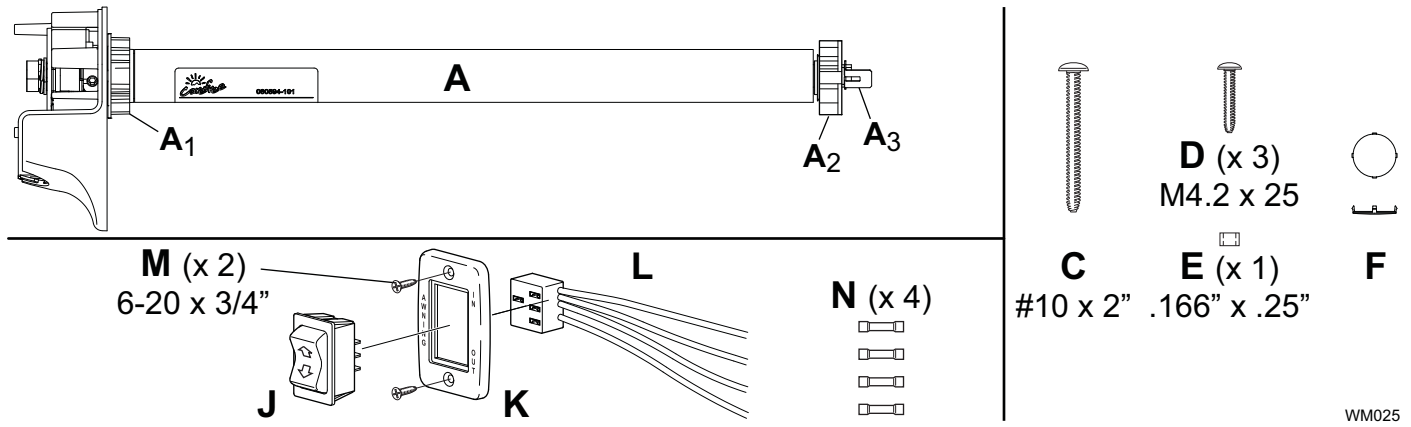

WM025

SPECIAL NOTE: For awnings built prior to September 2010, it is necessary to replace the idler (RH) end cap (p/n R001594WHT or R001594BLK). End cap is not included with motor upgrade kit. To confirm if end cap is required, check if end cap has a plug - if there is no plug, it will be necessary to replace.

End Cap with Plug



SECURE LEAD RAIL

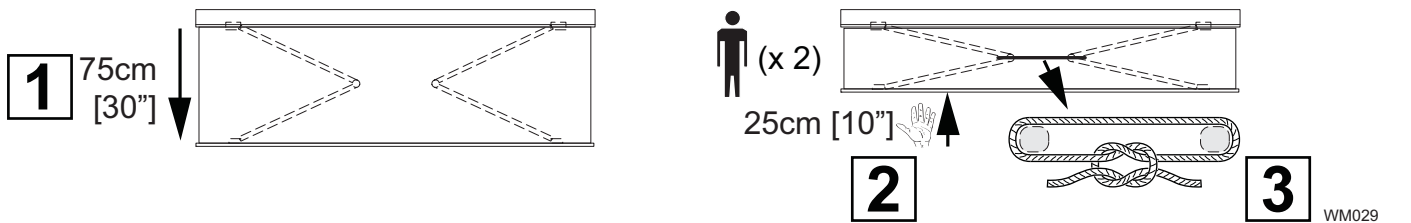

WM029

REMOVE CRANK

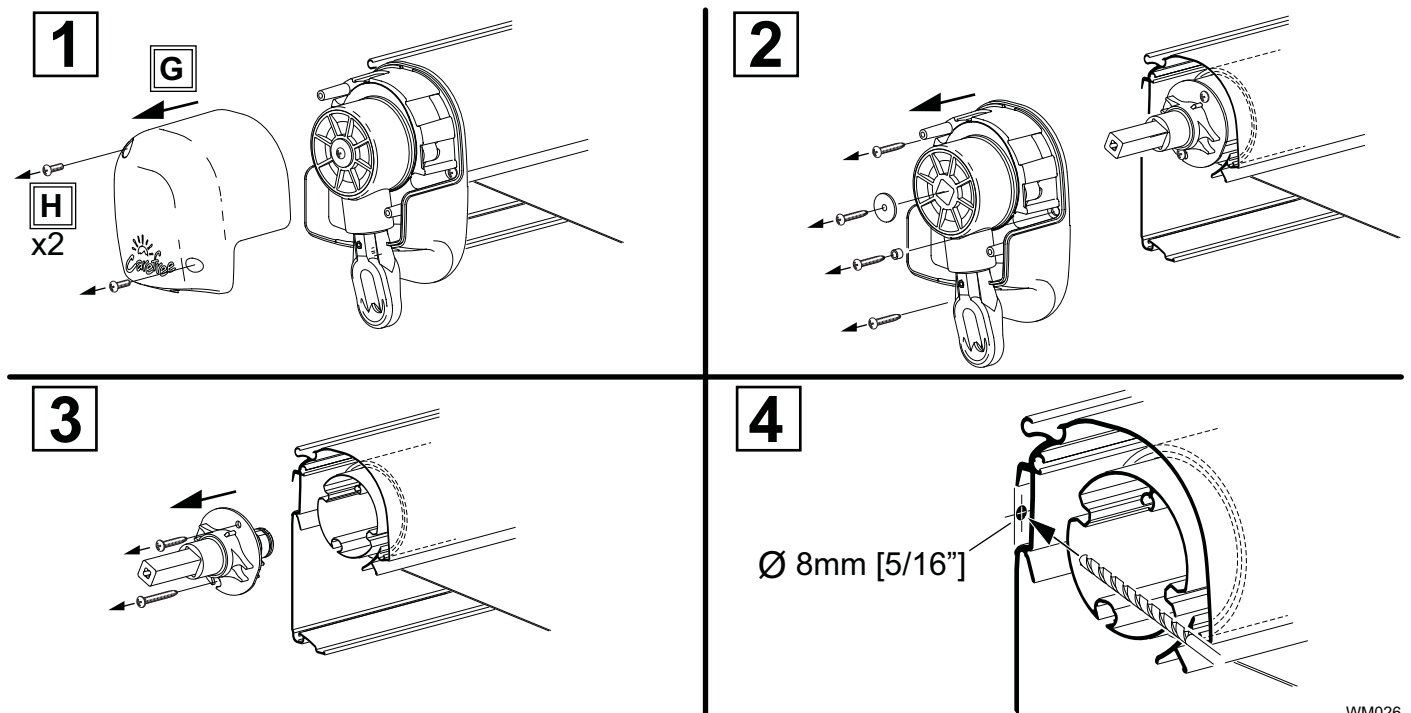

WM026

INSTALL MOTOR

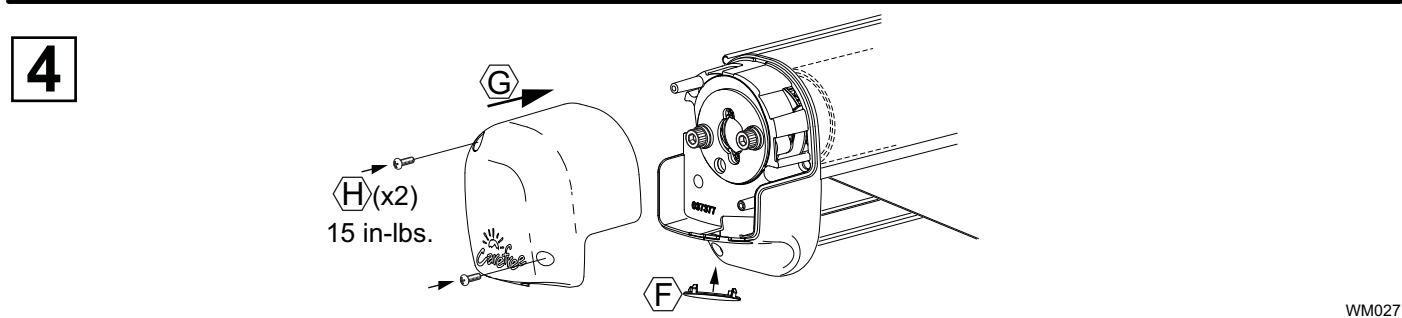
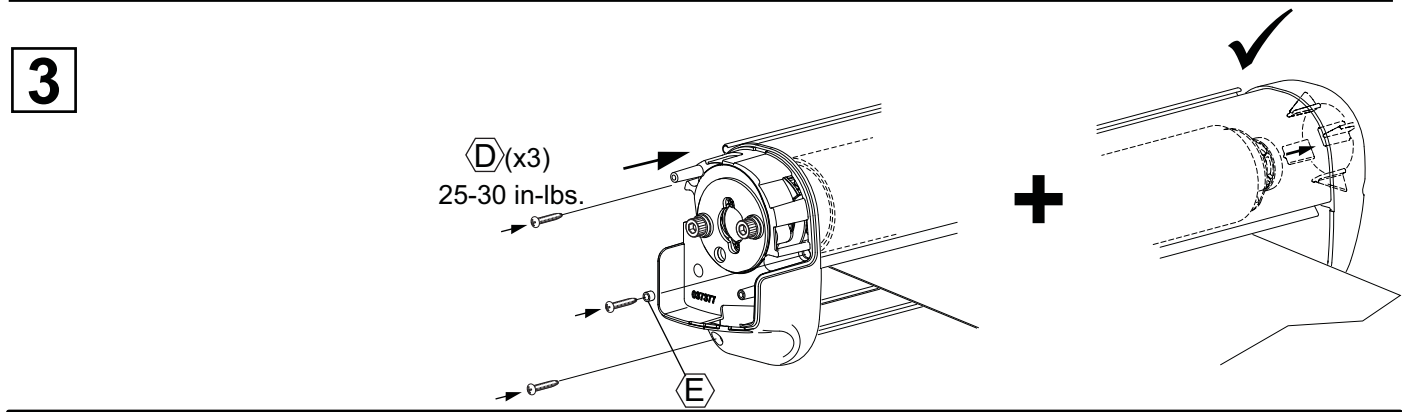
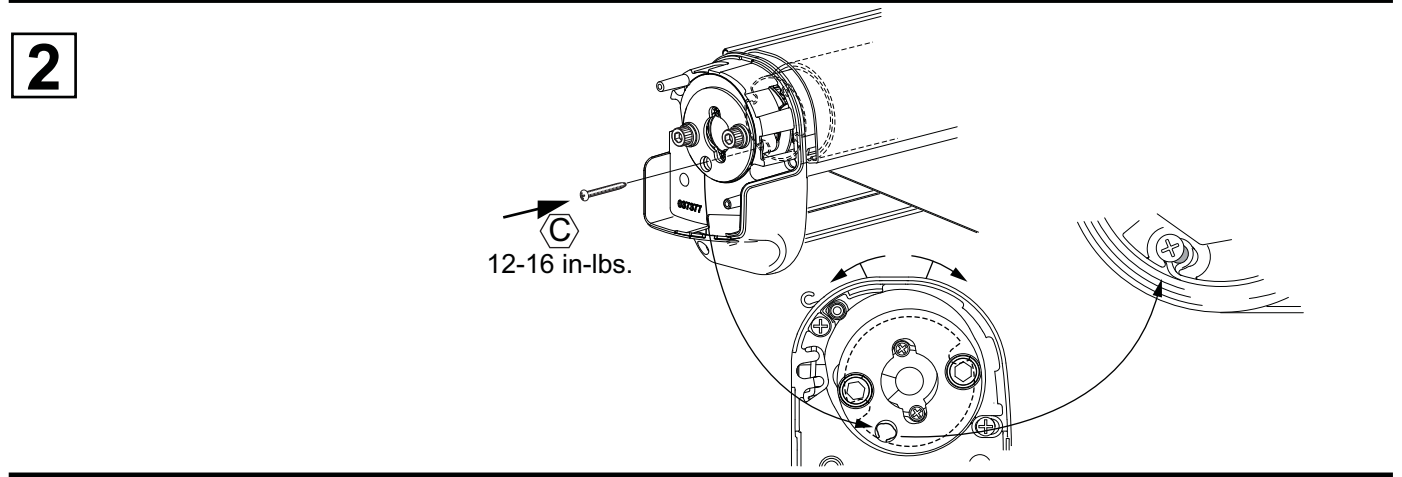
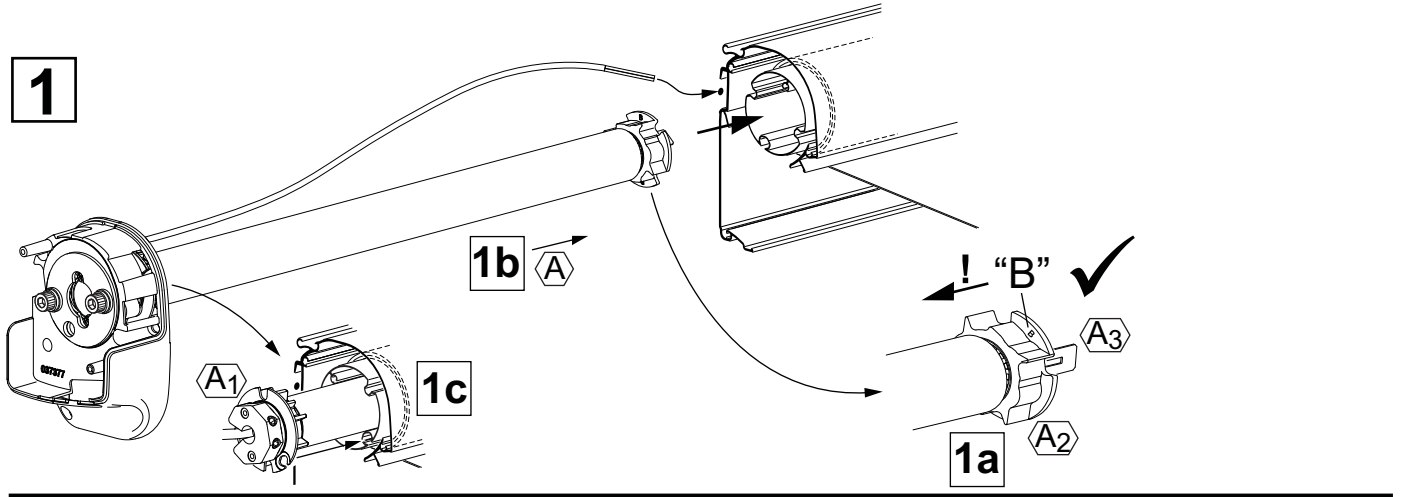

WM027

INSTALL SWITCH

1

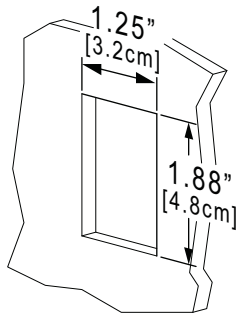

2

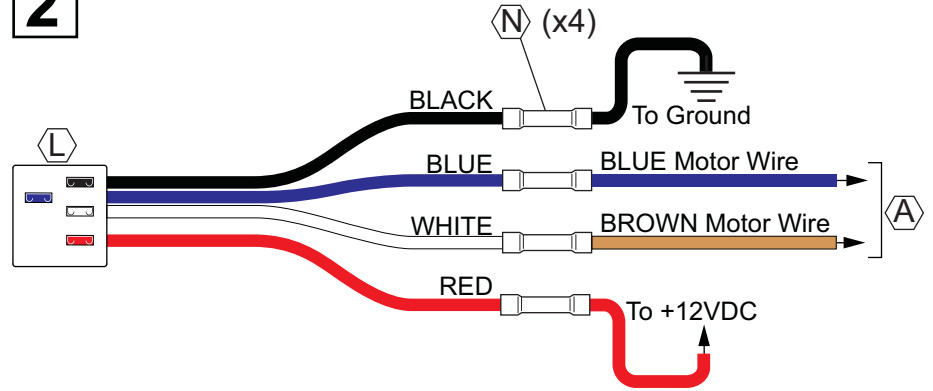

3

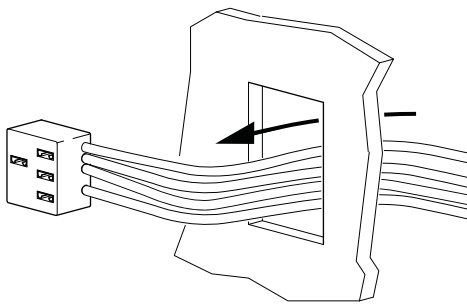

4

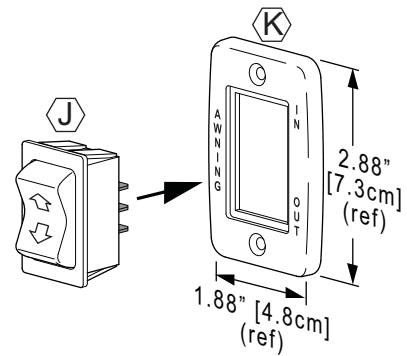

5

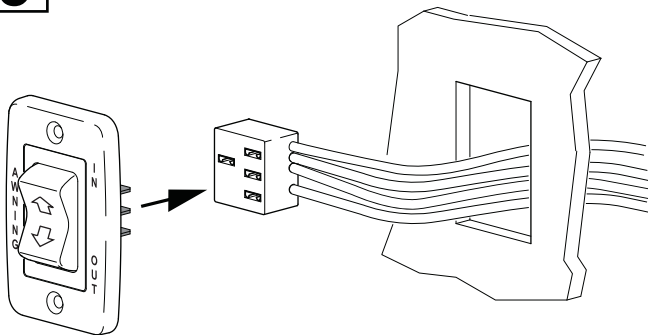

6

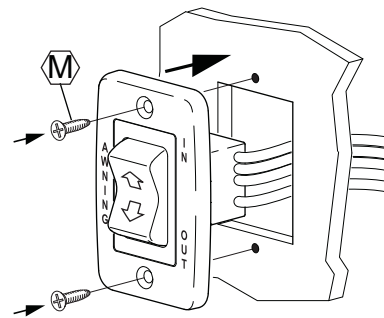

WM028

ADJUSTING THE MOTOR LIMITS

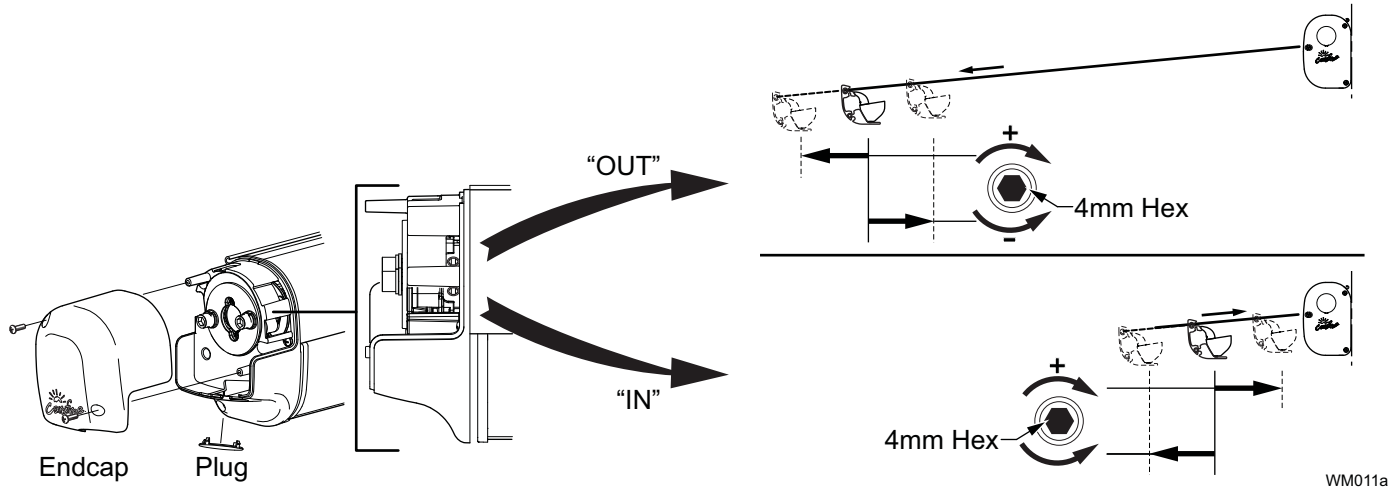

WM011a

OUT LIMIT SWITCH

The "OUT" limit switch stops the motor when the awning is fully extended

1. Extend the awning out completely.
2. Confirm that the arms are fully extended. The motor should stop and the fabric should be tight. If the motor continues to run, the fabric will sag; or, if the motor quits before the arms are fully extended, it will be necessary to adjust the "OUT" limit switch.
3. Using a 4mm Allen wrench turn the "OUT" limit switch. CLOCKWISE increases time the motor runs during extension, COUNTERCLOCKWISE reduces the time the motor runs.

NOTE: It is best to make the adjustments in increments of a single turn. 3 full turns of the screw equals approximately 2" of fabric extension.

4. Extend and retract the awning several times to confirm that the adjustment is correct.
5. Repeat steps 3 and 4 as required until the awning extends correctly.

IN LIMIT SWITCH

The "IN" limit switch stops the motor when the awning is fully retracted.

CAUTION THE IN-LIMIT SWITCH MUST BE SET TO SHUT OFF THE MOTOR WHEN THE AWNING IS CLOSED. THE MOTOR MUST NOT CONTINUE TO RUN AFTER THE AWNING IS CLOSED OTHERWISE DAMAGE TO THE MOTOR WILL OCCUR IF THE MOTOR CONTINUES TO RUN AFTER THE AWNING IS CLOSED.

1. Retract the awning in completely.
2. Confirm that the arms are fully retracted. The motor must stop when the awning is fully retracted. If the motor continues to run; or, if the motor quits before the arms are fully retracted, it will be necessary to adjust the "IN" limit switch.
3. Using a 4mm Allen wrench turn the "IN" limit switch. Clockwise increase time the motor runs during retraction, counter clockwise reduces the time the motor runs.

NOTE: It is best to make the adjustments in increments of a single turn. 3 full turns of the screw equals approximately 2" of fabric extension.

4. Extend and retract the awning several times to confirm that the adjustment is correct.
5. Repeat steps 3 and 4 as required until the awning retracts correctly.