



TRAVEL TRAILER HARDWARE

INSTRUCTION ADDENDUM

Section OneInstallation Instructions

Section TwoOperational Instructions

**USE THESE INSTRUCTIONS IN CONJUNCTION
 WITH THE REGULAR ONE-TOUCH INSTRUCTION
 MANUAL TO COMPLETE INSTALLATION OF ONE
 TOUCH TRAVEL TRAILER HARDWARE
 (SEE PAGE 3 FOR DETAILS)**

***USE THESE INSTRUCTIONS FOR PROPER OPERATION OF
 THE ONE-TOUCH TRAVEL TRAILER HARDWARE***



Review this diagram before preceding

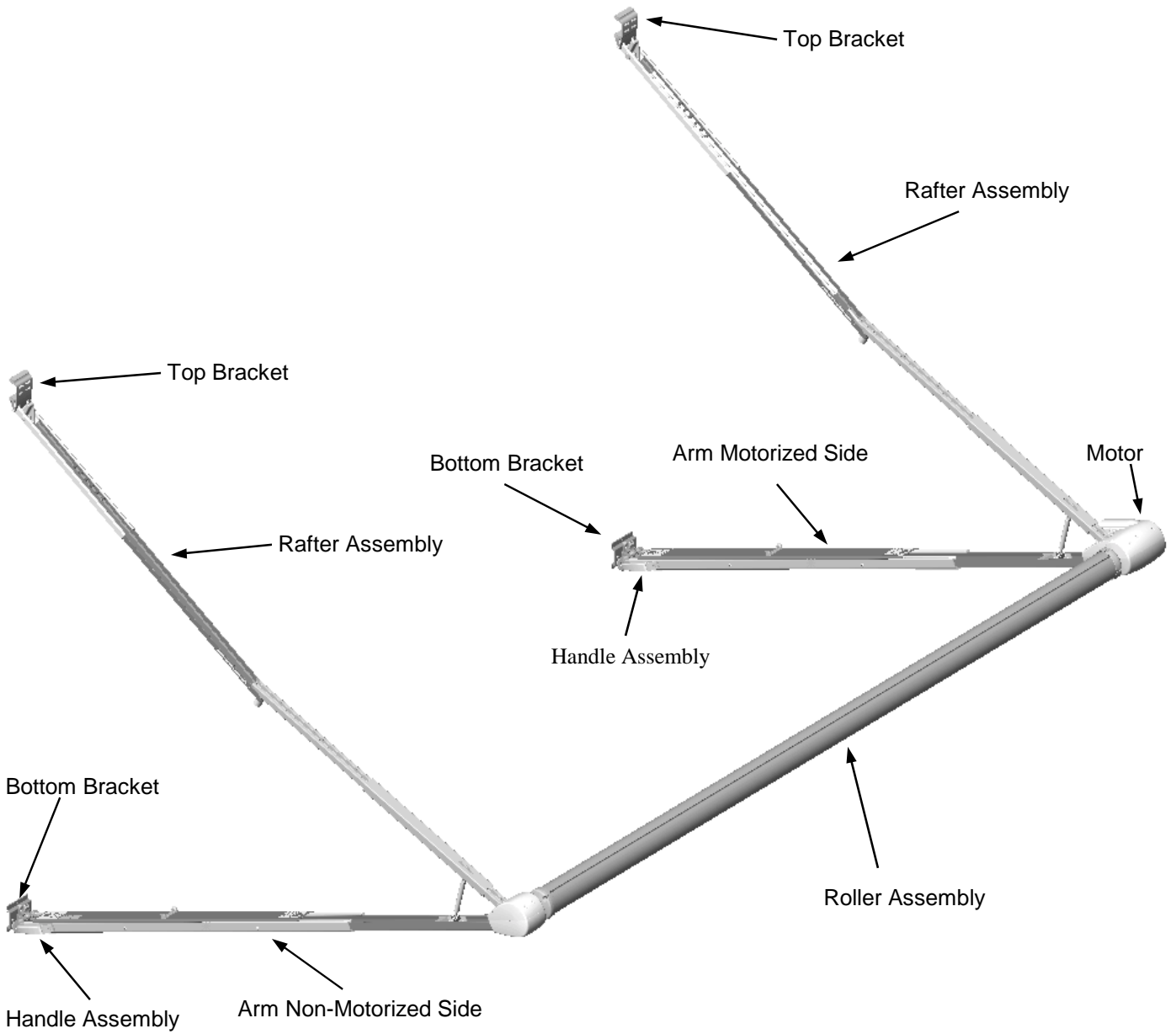

Section One

Installation Instructions

USE THESE INSTALLATION INSTRUCTIONS PAGE 2 THROUGH 7 AND THEN REFER TO THE REGULAR ONE-TOUCH MANUAL FOR THE REMAINDER OF THE INSTALLATION.

Read the entire contents of this manual prior to performing any portion of the installation. Use these instructions for the installation of the Carefree ONE-Touch awning only. Follow all cautions, warnings and notes to prevent injury or damage to the awning or the recreation vehicle.

Safety Information

Caution: Indicates a hazard that may cause minor or moderate personal injury or physical property damage if the caution is ignored.

Warning: Indicates a hazard that may cause serious personal injury or major physical property damage if the warning is ignored.

Note: Indicates information that may be helpful within the context of that particular step.

Tip: Provides helpful suggestions during the installation procedures or during actual use of the ONE-Touch awning.

Step One: Installation Recommendations

ONE INSTALLER (Two temporary helpers are beneficial)

TOOLS

- Tape Measure
- Step Ladder
- 15/16" Hole Saw
- 7/16" Socket/Nut Driver
- Ratchet or Speed Handle
- Flat or Round File
- Wire Crimper
- Diagonal Cutters
- 9/64" Hex Wrench
- Drill Motor
- 1/8" Drill Bit
- 3/16" Drill Bit
- #2 Phillips Screwdriver
- Caulking Gun
- Marking Pen
- Wire Stripper
- Square-drive Screwdriver #2

SUPPLIES

- Silicone Sealant
- Putty Tape (or equivalent)
- 14-gauge Primary Wire
- Silicone Spray Lubricant
- Heat Shrink Tubing
- Assorted Solderless Terminals

Step Two: Installation Preparation

Caution: The ONE-Touch awning must be mounted into the structural framework of the RV. Fiberglass or sheet metal siding alone is not strong enough to support the weight of the awning. Some trim moldings are aligned with actual floor members, but check to be sure. Mounting screws for the top and bottom brackets must attach solidly to the RV framework.

A. Verify the awning rail is installed properly. If no rail is installed, mount one using rivets or screws. Seal the back of the rail with butyl caulk or putty tape.

Caution: The awning rail must be secured to solid framework.

B. Be sure the awning rail is straight. Use a screwdriver to spread open the awning rail on the side the awning will be installed into (**figure 1**). Use a file to smooth the edges of the opening to avoid damaging the fabric.

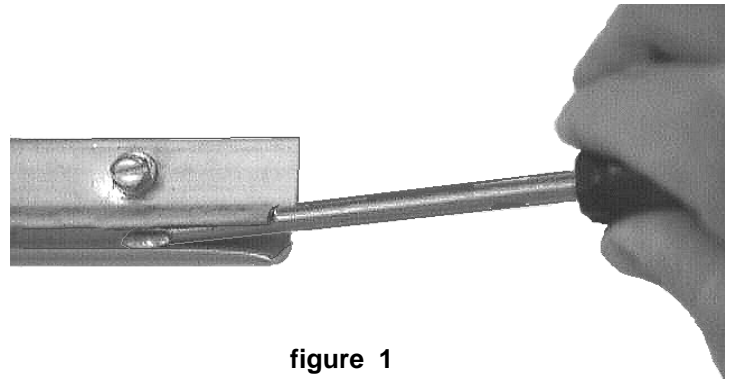

figure 1

Step Three: Install Bottom Brackets

A. Determine the optimum positioning of the awning arms on the RV. Be sure the arms will not interfere with appliance exhaust vents, mirrors, storage compartments, etc. Consider the correct positioning while noting the wiring outlet must be installed through the side of the RV at a point 3" - 5" below the awning rail and 1"- 4" to the left of the front arm assembly. (figure 9)

Caution: Be sure side wall-mounted fixtures, such as the porch lamp, will not interfere with the wiring harness for the ONE Touch awning.

Note: (1) The size of a roller assembly indicates the exact footage between the centers of each bottom bracket and arm assembly once installed. For example, a 16-foot roller assembly requires the centers of the bottom brackets to be 16 feet apart when installed on the RV.

(2) The distance between the centers of the bottom brackets must be within 1/2" of the distance between the eventual centers of the top brackets.

(3) If exchanging existing Carefree hardware with One-Touch hardware, secure the roller assembly to the RV and remove the arms, springs, and top brackets.

B. Mount the front and rear bottom brackets into the floor line structure using the two, #14 x 2-1/2" lag screws.

Tip: For best results, pre-drill the lag screw holes (with a 3/16" drill bit) through any trim or molding and slightly into the floor structure. Inject silicone sealant into the holes before installing the lag screws.

Step Four: Attaching the Arms to the Roller Assembly (Timing The Awning)

A. Carefully remove the roller assembly and ONE-Touch hardware from their packaging. Do not remove the plastic wrap on the arm assemblies or the flagged cotter pin from the non-motorized arm assembly at this time.

B. When the awning arms are attached to the roller assembly they should closely match figure 2 showing the awning assembly viewed from the motorized and non-motorized sides. Start by aligning the three V-shaped openings in the drive wheel with the three slots on the inside of the roll bar and inserting the drive wheel into the open end of the roller assembly.

Note: The polyrod on roller assemblies or driprail on roller assemblies with Alumaguard must remain on the back side of the awning assembly for the ONE-Touch awning to operate properly.

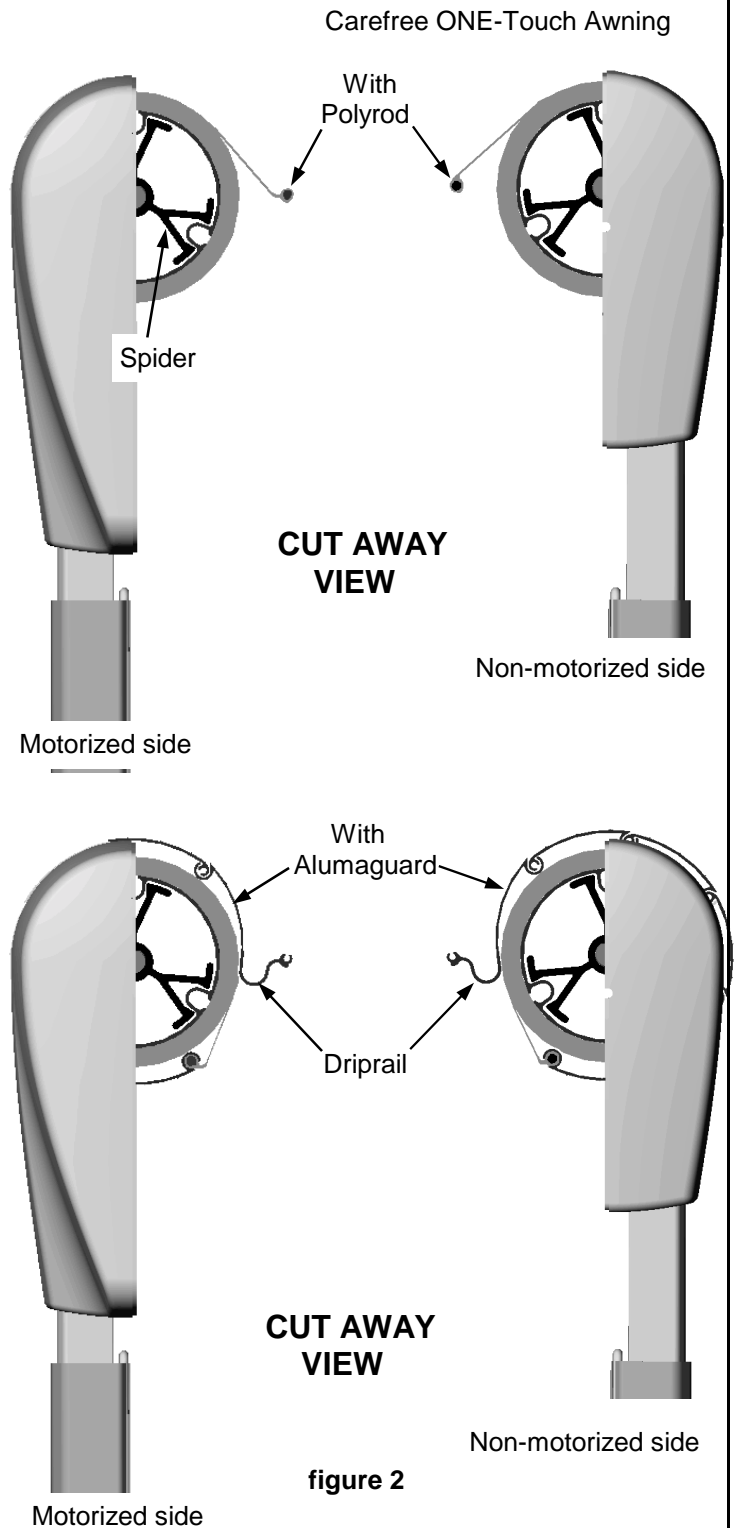

figure 2

C. Rotate the end cap (it can be turned independent of the shaft) until its open slot aligns with the empty slot in the roller assembly; the other two slots in the roller assembly will have polyrod in them. Finish pushing the drive wheel all the way into the roller assembly; the end cap should seat squarely against the end of the roller assembly when inserted all the way in.

Warning: Exercise caution when handling the attached arm and roller assembly. The arm assembly must remain perpendicular to the roller assembly (see page 2). Failure to handle the arm assembly in this manner will bend the drive shaft.

D. Secure the end cap to the roller assembly using two, #10 square-drive screws (**figure 3**).

E. Repeat steps 4A through 4D for the non-motorized arm assembly.

F. Remove the flagged cotter pin from the non-motorized arm assembly after the arm is attached.

Warning: Exercise caution when handling the attached arms and roller assembly. The arm assemblies must remain perpendicular to the roller assembly (see page 2). Failure to handle the arm assemblies in this way will bend the drive shafts.

G. Unwrap one full turn of fabric or fabric & Alumaguard from the roller assembly to allow for clearance around mirrors, lamps, etc., when sliding the roller assembly polyrod or Alumaguard drip rail into the awning rail mounted on the RV.

Note: If exchanging existing Carefree hardware with One-Touch hardware, secure roller assembly to RV and remove existing arms, springs, and top brackets. Refer to **Step 5** for adjusting Arms to proper length. Install each Arm into its bottom bracket and unwrap the roller assembly one full turn. Precede with steps 4-A through 4-F for fitting the Arms To the Roll Bar.

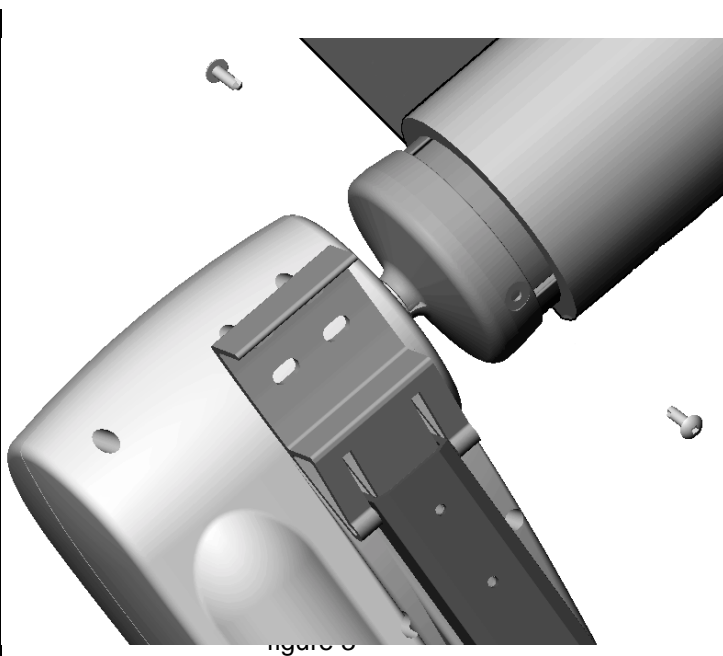

figure 3

Carefree ONE-Touch Awning

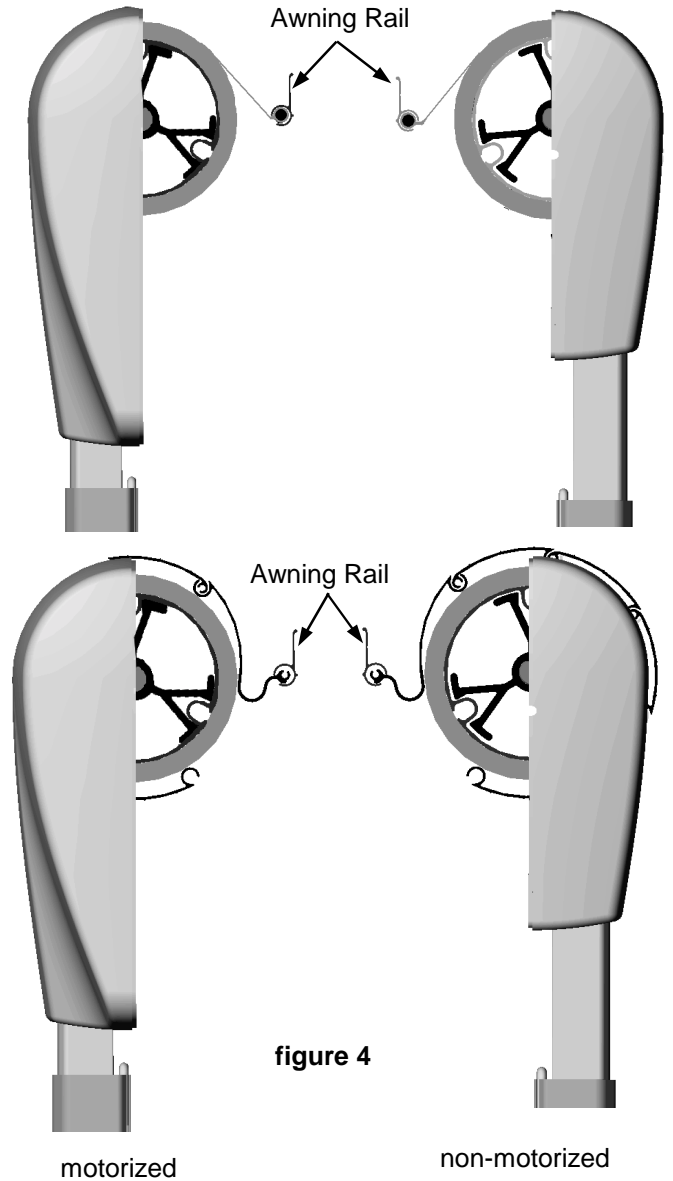

figure 4

Step Five: Installing the Awning Assembly on the RV.

A. When the awning assembly is installed on the RV it should closely match (**figure 4**) showing the awning assembly viewed from the motorized and non-motorized sides.

B. When installed the center of the roller assembly should be in line with the awning rail. The height is set by using the adjustable arm and Lift handle. (figure next page)

C. Measure the distance between the bottom brackets and the awning rail (figure 6).

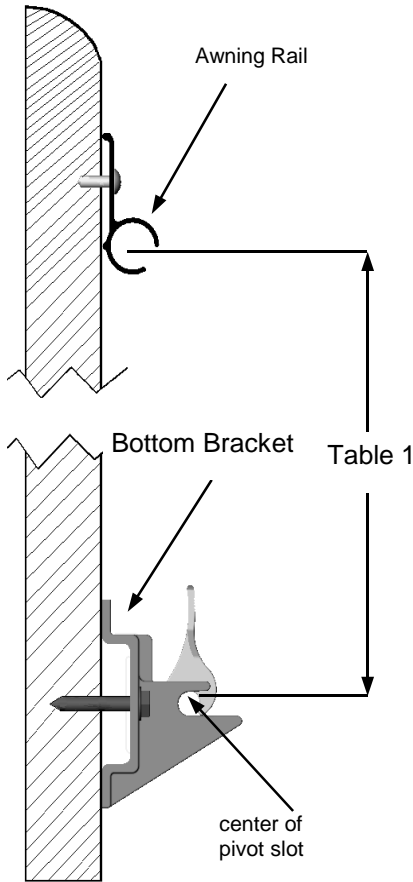
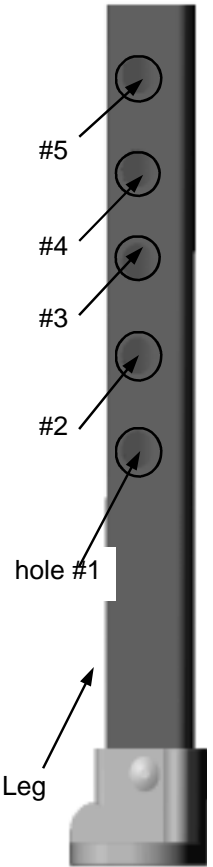

figure. 6

Table 1

Measurement in figure 6	Hole number below is where handle pin should be	Length of adjustable leg
76"	4	14.5"
77"	5	
78"	6	
79"	7	
80"	8	
81"	9	
82"	10	
83"	11	
84"	12	
85"	13	



Note: There are a Total of 11 Holes. Only 5 shown here

D. Pull Lift Handle outward (6A) and adjust the motorized arm assembly to the proper length using Table 1. Match the measurement taken in step 6 to the appropriate numbered hole in the adjustable leg where the handle pin will insert. Line pin of the handle up with the appropriate hole and release handle. (Figure 7) (right)

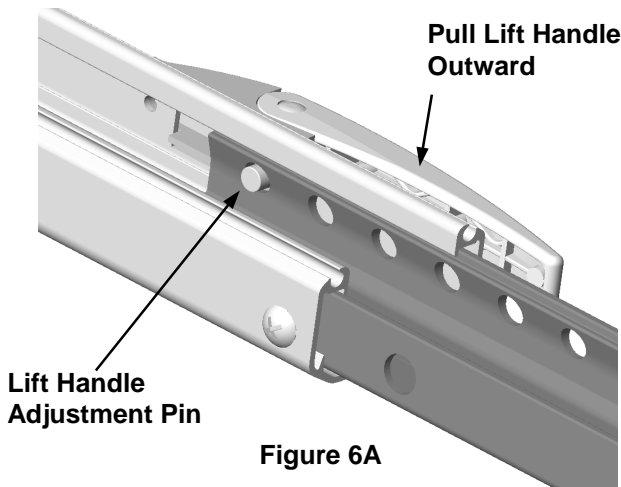

Figure 6A

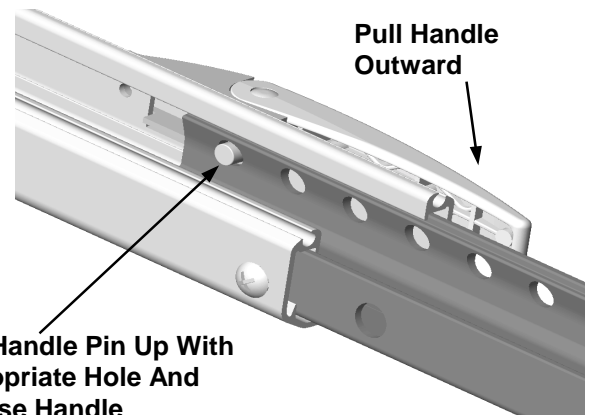

Figure 7

E. Once the handle pin is positioned in the appropriate hole per Table 1, count down three holes. This is where the arm stop will be located.

F. Install arm stop by inserting the bolt through the aluminum block and then from the inside of the arm, through the 3rd hole down from where the handle pin is. Thread round nut onto bolt from outside of the adjustable arm.

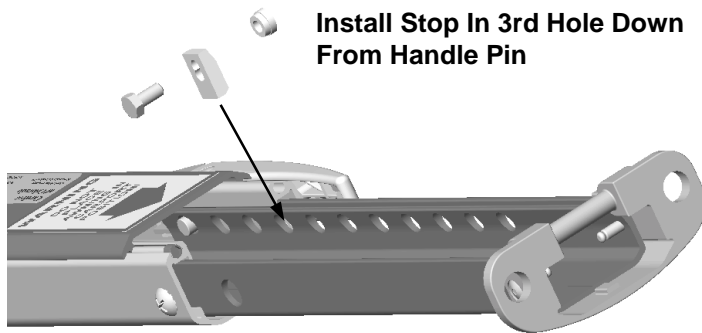

Figure 8 Stop Bolt Installed

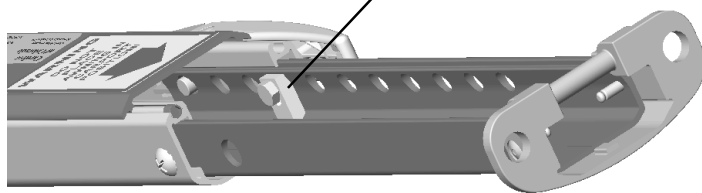

Figure 9

D. Repeat steps 5A through 5D for adjusting the length of the non-motorized arm assembly.

Note: Both the motorized and non-motorized arm assemblies should use the same numbered hole when releasing the handle pin into the hole of the adjustable arm.

E. Now that the ONE-Touch awning is assembled and adjusted for the RV, use two helpers to lift the awning into a vertical position so the roller assembly is at the top.

Warning: Exercise caution when lifting and handling the awning assembly. Both arm assemblies must remain perpendicular to the roller assembly and parallel to each other (see page 2). Failure to handle the awning arms in this way will bend the drive shafts.

Tip: Silicone spray lubricant applied to the awning rail will allow for easier installation during step 5F.

F. Carefully slide the awning polyrod or the Alumaguard drip rail into the awning rail as the helpers alternately guide the front and rear arms (figure 10).

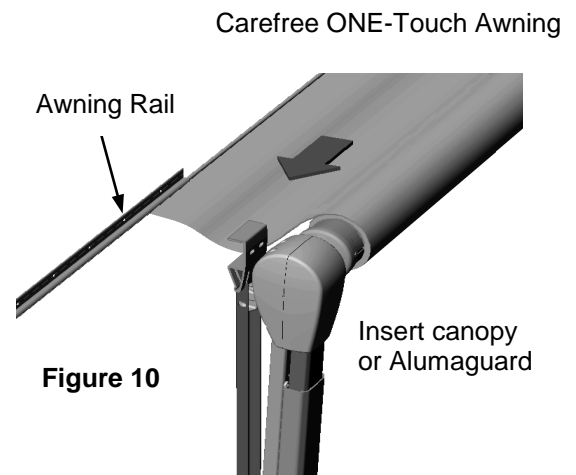

Figure 10

G. Once the awning arms are aligned with the previously installed bottom brackets, snap the bottom portion of each adjustable leg into its bottom bracket and allow the awning to lean away from the side of the RV.

Step Six: Install the Top Brackets

A. Remove the plastic wrap from the motorized arm assembly and position of upper bracket at the awning rail. The top bracket should straddle the awning rail and be positioned fully up against the bottom of the rail (figure 11). The brackets should be straight up and down (not angled) for proper operation. (See below for your style of bracket)

Note: The distance between the centers of the top brackets must be within $\frac{1}{2}$ " of the distance between the centers of bottom brackets. Also the awning arms must be perpendicular to the awning roller assembly (see page 2).

B. Secure the bracket into the roof line using two, #14 x 3" lag screws.

Tip: For best results, pre-drill the lag screw holes with a $\frac{3}{16}$ " bit through the awning rail and slightly into the structural support member. Inject silicone sealant into the holes before installing the lag screws.

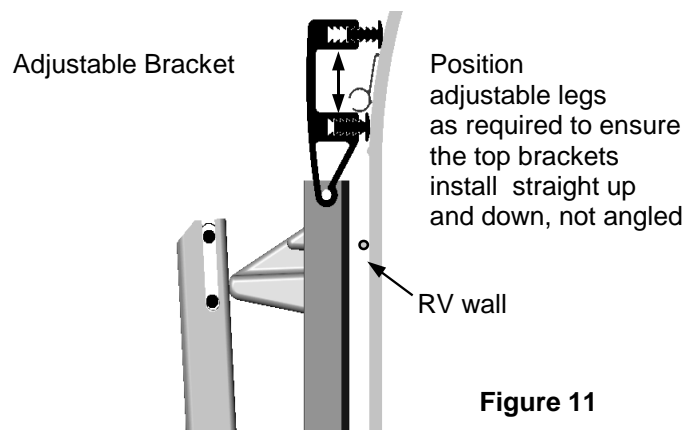

Figure 11

THIS PORTION OF THE INSTALLATION IS NOW COMPLETE. FOR THE REST OF THE INSTALLATION, FOLLOW THE "GOLD" MANUAL BEGINNING ON PAGE 8.

Section Two

Operational Instructions

THE ONE-Touch "GOLD" AWNING CAN BE USED ONLY IN THE MANUAL MODE. THE MANUAL MODE REQUIRES YOU TO PLACE THE RIGHT SIDE ROCKER SWITCH ON THE SWITCH PANEL IN THE "MANUAL" POSITION AND THEN DEPRESS THE OTHER SWITCH TO EXTEND AND RETRACT AWNING.

Warning: If the awning is partially deployed the awning will not be resistant to wind; partial extension is recommended in calm conditions only. Additionally, Do not extend the awning in gusty wind conditions. **If the awning is to be left unattended or used in breezy wind conditions, it is highly recommended that the Wind Braces provided to be positioned between both Rafter assemblies and Arm assemblies.**

Note: The RV must be positioned relatively level for the Carefree ONE-Touch awning to operate properly.

Tip: For optimum performance, be sure the battery systems are fully charged or the power converter energized.

How the Power Control Module Works

To prevent damage to the ONE-Touch motor and circuitry, the Power Control Module monitors the current drawn by the motor. If the current draw exceeds the preset factory level, the power control module shuts off the power to the awning momentarily. This will occur if the power switch continues to be operated after the awning is fully retracted or extended. To reduce wear on the awning and it's power system do not continue to operate the power switch after full extension or retraction.

Step One: To Extend or Retract the Awning

A. TO EXTEND: Place the 3 position Rocker Switch on the right hand side of the Switch Panel in the Manual position by pushing down on the switch at the location marked "Manual". (figure 17) Operate the power switch in the "EXTEND" mode. Extend the awning until the roller assembly stops turning. At this point the fabric will be slightly slack. Jog the "RETRACT and/ or EXTEND" switch slightly to tighten canopy.

Note: If the awning is only to be partially extended, simply release the momentary rocker switch when the awning is extended to the point desired.

B. Pull the Arm Lift Handle outward on one end until the handle pin disengages from the hole in the lower foot. With one hand holding the handle outward and the other on the arm, elevate the front of the awning to the desired height. **NOTE: IN SOME APPLICATIONS, ELEVATING THE FRONT OF THE AWNING CAN HELP TO GAIN DOOR CLEARANCE, PLUS IT ALLOWS YOU TO POSITION ONE END OF THE AWNING HIGHER THAN THE OTHER TO ASSIST WITH WATER RUN OFF. THIS DOES NOT HOWEVER APPLY TO ALL INSTALLATIONS.**

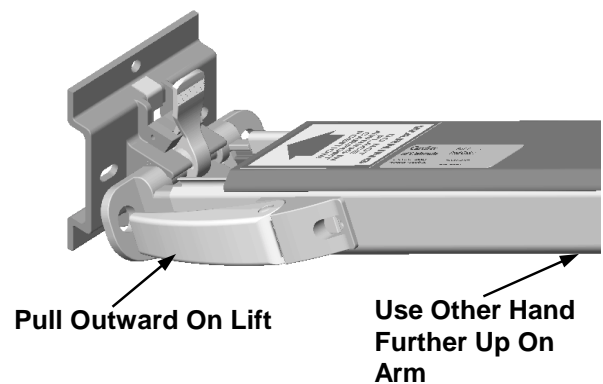

A. TO RETRACT: Carefully pull upward on lift handle with one hand while hanging on to awning arm with the other. Once the handle pin is released from the engaging hole in the lower foot, lower arm down to its lowest position.

B. With the right hand switch of the switch panel still in the **Manual Position**, operate the power switch in the "RETRACT" position until the awning is fully retracted.

C. Place switch panel in the **OFF** position.

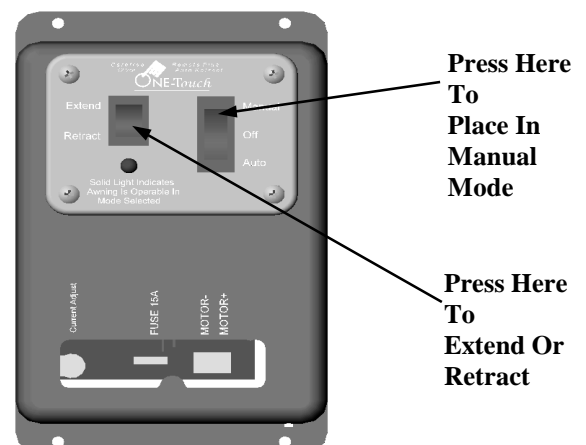

Section Two

Operational Instructions (cont.)

Emergency Retraction of Awning

If an alternative 12 volt power source is available:

If power from the RV is unavailable for operation, the Carefree ONE-Touch awning can be safely retracted by **disconnecting the power plug (located on the outside of wall of RV) and applying a positive and negative 12-volts to the two terminals located on the bottom side of the motor housing.**

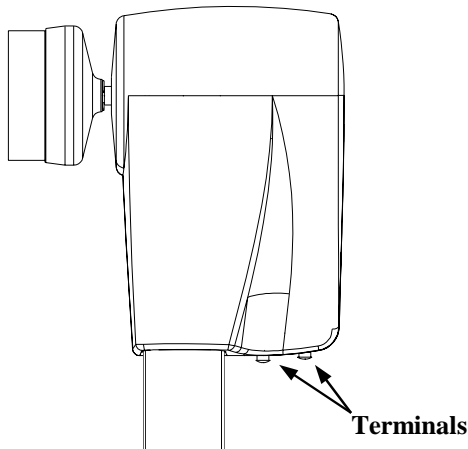

Using the jumper cables provided attach a jumper lead to each of the terminals. Connect other ends of jumper Cables to 12V source. If the awning does not retract reverse the leads.

Caution: Be careful when retracting the awning in this manner as the awning may move abruptly; it will be necessary to maintain contact with each of the two terminals throughout the retraction process.

If no alternative 12 volt power source is available:

If power from the RV is unavailable for operation and no alternative 12 Volt power source is available,

The Carefree ONE-Touch awning can be safely retracted by disconnecting the power plug (located on the outside of wall of RV) and using a reversible electric drill fitted with the straight 9/64" hex key provided to turn the motor or using the L shaped hex key and turning it by hand.

The portion of the motor that can be turned is accessible though an opening at the base of the motor housing.

Caution: Operate the drill in reverse at a low power setting to retract the awning. It will be necessary to turn the motor with the drill throughout the retraction process.